

COUNTY STATE AID HIGHWAY 26

CONSTRUCTION PLAN FOR: PLACE AGGREGATE SHOULDERS

LOCATED BETWEEN T.H. 15 & EAST COUNTY LINE (GEOGRAPHIC DESCRIPTION)

LOCATED BETWEEN A POINT 1,300' EAST OF WEST 1/4 COR. SEC. 9 T102N. R30W. TO A POINT 52' EAST OF EAST 1/4 COR. SEC. 12 T102N. R 29W. (LEGAL DESCRIPTION)

GROSS LENGTH	51,555.00	FEET	9.764	MILES
BRIDGES LENGTH	0.00	FEET	0.000	MILES
EXCEPTIONS LENGTH	0.00	FEET	0.000	MILES
NET LENGTH	51,555.00	FEET	9.764	MILES

INDEX OF SHEETS

SHEET NO. 1	TITLE SHEET & LAYOUT MAP
SHEET NO. 2	ESTIMATED QUANTITIES & TYPICAL SECTIONS
SHEET NO. 3-28	CROSS SECTION SHEETS

THIS PLAN CONTAINS 28 SHEETS

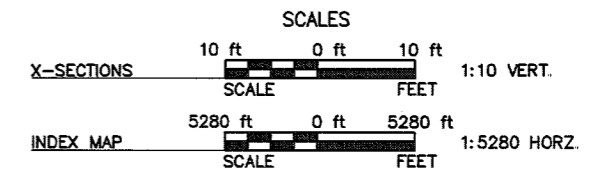

END S.A.P. 46-626-20  
STA. 528+51

BEGIN S.A.P. 46-626-20  
STA. 13+00

GOVERNING SPECIFICATIONS

THE MINNESOTA DEPARTMENT OF TRANSPORTATION STANDARD SPECIFICATIONS FOR CONSTRUCTION 2005 EDITION DATED AUGUST 31, 2005.

ALL APPLICABLE FEDERAL, STATE, AND LOCAL LAWS AND ORDINANCES WILL BE COMPLIED WITH, IN THE CONSTRUCTION OF THIS PROJECT.

I HEREBY CERTIFY THAT THIS PLAN WAS PREPARED BY ME OR UNDER MY DIRECT SUPERVISION AND THAT I AM A DULY REGISTERED PROFESSIONAL ENGINEER UNDER THE LAWS OF THE STATE OF MINNESOTA.

*Kevin Payne*  
COUNTY ENGINEER

DATE 3/24/2009

MARTIN COUNTY

REG. NO. 40,907

*Al E. Saeder*  
DISTRICT STATE AID ENGINEER: REVIEWED FOR COMPLIANCE WITH STATE-AID RULES/POLICY.

DATE 5/5/09

*Al E. Saeder*  
APPROVED: FOR STATE AID FUNDING STATE AID ENGINEER.

DATE 5/5/09

PLAN SYMBOLS

- STATE LINE  
COUNTY LINE  
TOWNSHIP OR RANGE LINE  
SECTION LINE  
QUARTER LINE  
SIXTEENTH LINE  
RIGHT-OF-WAY LINE  
SLOPE CASHEMENT  
PRESENT RIGHT-OF-WAY LINE  
CONTROL OF ACCESS LINE  
PROPERTY LINE (Except Land Lines)  
VACATED PLATTED PROPERTY  
CORPORATE OR CITY LIMITS  
TRUNK HIGHWAY CENTER LINE  
RETAINING WALL  
RAILROAD  
RAILROAD RIGHT-OF-WAY LINE  
RIVER OR CREEK  
DRY RUN  
DRAINAGE DITCH  
DRAINAGE TILE  
CULVERT  
DROP INLET  
GUARD RAIL  
BARBED WIRE FENCE  
WOODEN WIRE FENCE  
CHAIN LINK FENCE  
RAILROAD SNOW FENCE  
STONE WALL OR FENCE  
HEDGE  
RAILROAD CROSSING SIGN  
RAILROAD CROSSING BELL  
ELECTRIC WARNING SIGNAL  
CROSSING GATE  
MEANDER CORNER  
SPRINGS  
MARSH  
TIMBER  
ORCHARD  
BRUSH  
NURSERY  
CATCH BASIN  
FIRE HYDRANT  
CATTLE GUARD  
OVERPASS (Highway Over)  
UNDERPASS (Highway Under)  
BRIDGE  
BUILDING  
IRON PIPE OR ROD  
MONUMENT (STONE, CONCRETE, OR METAL)  
WOODEN HUB  
GRAVEL PIT  
SAND PIT  
BERMUD PIT  
ROCK QUARRY
- UTILITIES SYMBOLS
- POWER POLE  
TELEPHONE POLE  
JOINT TELEPHONE AND POWER ON POWER POLES  
IN TELEPHONE POLES  
ANCHOR  
STEEL TOWER  
STREET LIGHT  
PEDESTAL TELEPHONE CABLE TERMINAL  
GAS MAIN  
WATER MAIN  
GATE VALVE  
CONDUIT  
TELEPHONE CABLE IN CONDUIT  
ELECTRIC CABLE IN CONDUIT  
TELEPHONE MANHOLE  
ELECTRIC MANHOLE  
BURIED TELEPHONE CABLE  
BURIED ELECTRIC CABLE  
AERIAL TELEPHONE CABLE  
SEWER (SANITARY OR STORM)  
SEWER MANHOLE

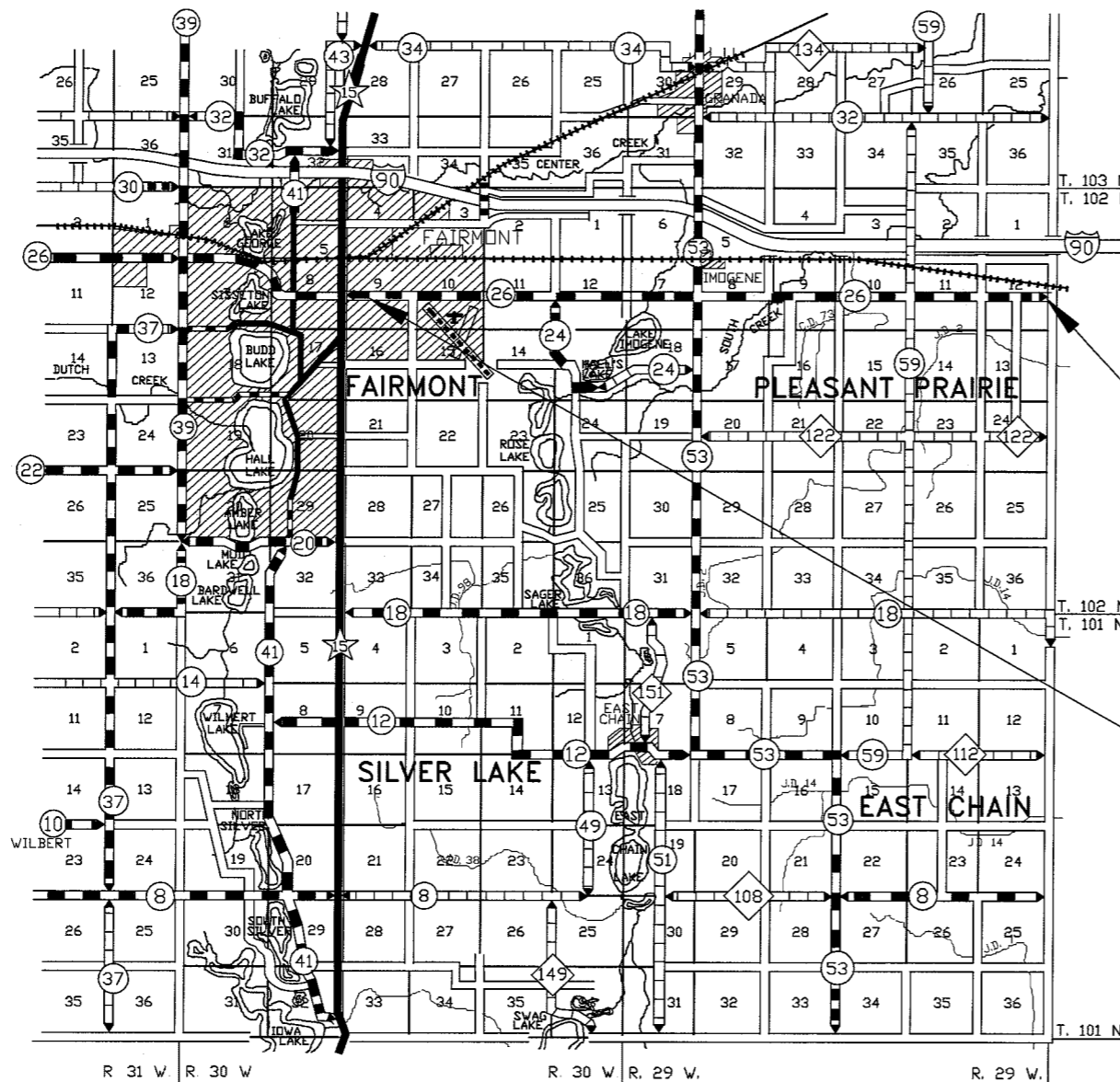

DESIGN DESIGNATION (RURAL)

ADT (CURRENT YEAR) 2,448 (2009)  
ADT (FUTURE YEAR) 3,427 (2029)  
9 TON DESIGN  
DESIGN SPEED 55 MPH  
SOIL FACTOR 130%  
SHOULDER WIDTH 8 FEET  
STOPPING SIGHT DISTANCE:  
HEIGHT OF EYE 3.5 FEET  
HEIGHT OF OBJECT 0.5 FEET

### TYPICAL SECTIONS

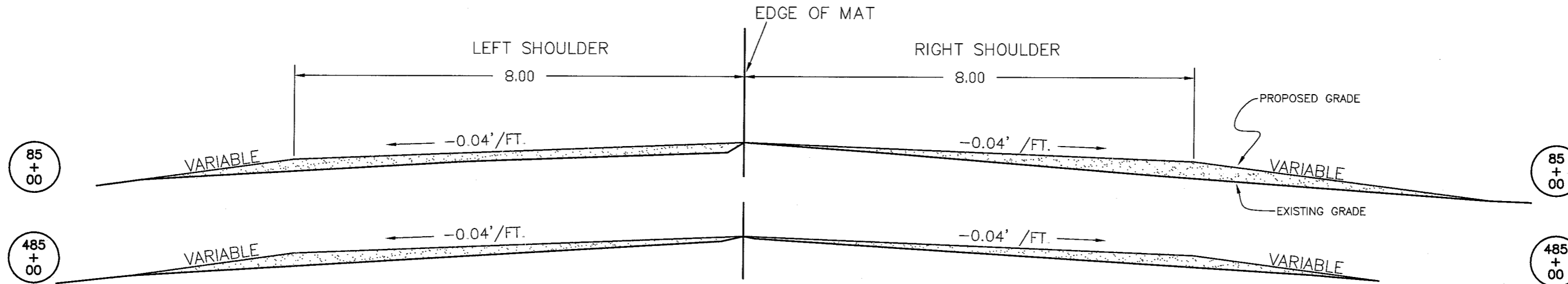

### ESTIMATED QUANTITIES

SPECIFICATION NO.	ITEM	UNIT	TOTAL ESTIMATED QUANTITIES
1). 2221.501	AGGREGATE SHOULDERING CLASS 5	TON	11,488

### BITUMINOUS PAVED SHOULDERS

STA. 86+78 TO STA. 89+95 LT.	STA. 51+34 TO STA. 53+26 RT.
STA. 125+82 TO STA. 129+47 LT.	STA. 59+09 TO STA. 67+82 RT.
STA. 157+34 TO STA. 158+74 LT.	STA. 88+72 TO STA. 93+33 RT.
STA. 165+07 TO STA. 166+00 LT.	STA. 154+76 TO STA. 158+73 RT.
STA. 201+04 TO STA. 201+95 LT.	STA. 165+00 TO STA. 166+00 RT.
STA. 209+83 TO STA. 211+05 LT.	STA. 209+71 TO STA. 211+08 RT.
STA. 234+15 TO STA. 234+99 LT.	STA. 221+62 TO STA. 222+66 RT.
STA. 245+01 TO STA. 245+97 LT.	STA. 252+28 TO STA. 253+28 RT.
STA. 264+25 TO STA. 270+89 LT.	STA. 259+62 TO STA. 272+02 RT.
STA. 285+37 TO STA. 286+39 LT.	STA. 309+58 TO STA. 310+74 RT.
STA. 290+88 TO STA. 291+86 LT.	STA. 319+31 TO STA. 321+15 RT.
STA. 317+18 TO STA. 318+31 LT.	STA. 330+11 TO STA. 331+53 RT.
STA. 343+85 TO STA. 344+78 LT.	STA. 337+59 TO STA. 338+41 RT.
STA. 369+78 TO STA. 371+25 LT.	STA. 369+48 TO STA. 370+94 RT.
STA. 400+11 TO STA. 401+04 LT.	STA. 383+25 TO STA. 384+16 RT.
STA. 422+68 TO STA. 424+19 LT.	STA. 422+42 TO STA. 424+16 RT.
STA. 475+22 TO STA. 476+90 LT.	STA. 475+15 TO STA. 476+35 RT.
STA. 527+99 TO STA. 528+01 LT.	STA. 491+73 TO STA. 494+67 RT.
	STA. 501+50 TO STA. 502+70 RT.
	STA. 527+92 TO STA. 528+01 RT.

### BASIS FOR ESTIMATED QUANTITIES

\* AGGREGATE SHOULDERING CLASS 5 140 LBS/CU. FT. COMPACTED DRY WEIGHT & 4% MOIST.

### NOTES

- (1.) INCLUDES 4,975 TONS FOR RIGHT SHOULDER MAINLINE
- (1.) INCLUDES 4,448 TONS FOR LEFT SHOULDER MAINLINE
- (1.) INCLUDES 132 TONS FOR ROAD APPROACHS
- (1.) INCLUDES 208 TONS FOR FARM ENTRANCES
- (1.) INCLUDES 1,270 TONS FOR SINGLE FIELD ENTRANCES
- (1.) INCLUDES 455 TONS FOR DOUBLE FIELD ENTRANCES

