

FORMER PROJECTS

S.P. 46-612-01 GRADING & GRAVEL SURFACE -1957
 S.A.P. 46-614-05 GRADING & GRAVEL SURFACE-1966
 S.A.P. 46-614-06 GRAVEL BASE & BIT. SURFACE-1967
 C.P. 76:03 BITUMINOUS LEVEL & WEAR -1976
 COURSES & AGG. SHOULDERING

MINN PROJECT NO.
 MINNESOTA DEPARTMENT OF TRANSPORTATION
COUNTY STATE AID HIGHWAY NO. 39

CONSTRUCTION PLAN FOR: BITUMINOUS WEAR COURSE
 & AGGREGATE SHOULDERING

LOCATED BETWEEN JCT. C.S.A.H. 38 NORTH TO THE JCT. C.S.A.H. 50
 (GEOGRAPHIC DESCRIPTION)

LOCATED BETWEEN SE CORNER SECTION 12 T103N R31W
TO SE CORNER SECTION 12 T104N R31W
 (LEGAL DESCRIPTION)

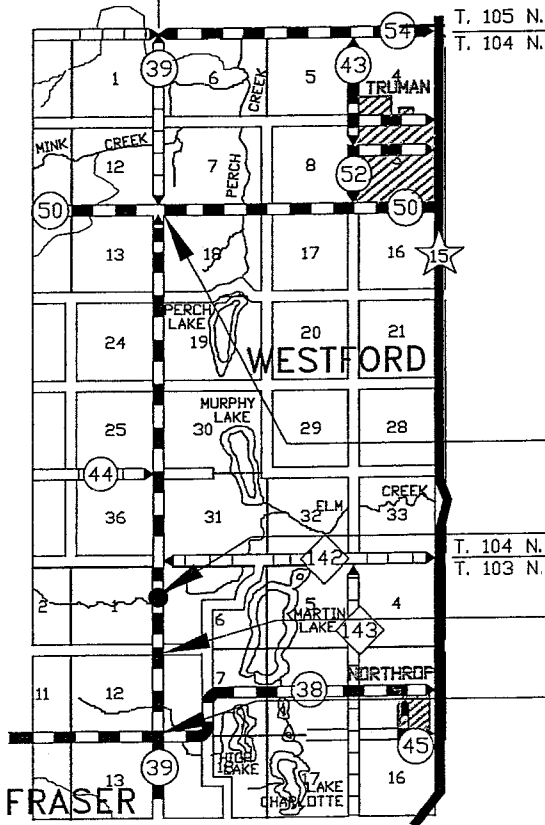

S.A.P. 46-639-11

GROSS LENGTH	31,783.80 FEET	6.020 MILES
BRIDGES LENGTH	93.16 FEET	0.018 MILES
EXCEPTIONS LENGTH	00.00 FEET	0.000 MILES
NET LENGTH	31,783.80 FEET	6.020 MILES

INDEX OF SHEETS

- SHEET NO. 1 TITLE SHEET & LAYOUT MAP
- SHEET NO. 2 ESTIMATED QUANTITIES
- SHEET NO. 3 TYPICAL SECTIONS

THIS PLAN CONTAINS 3 SHEETS

BEGIN S.A.P. 46-639-11

STA. 108+99.5

BRIDGE # 46508

STA. 342+23.42 TO STA. 343+16.58

EQUATION- STA. 372+55.8 =
STA. 372+61.6: -5.8'

END S.A.P. 46-639-11

STA. 426+83.3

GOVERNING SPECIFICATIONS

THE MINNESOTA DEPARTMENT OF TRANSPORTATION STANDARD SPECIFICATIONS FOR CONSTRUCTION 2005 EDITION DATED AUGUST 31, 2005.

ALL APPLICABLE FEDERAL, STATE, AND LOCAL LAWS AND ORDINANCES WILL BE COMPLIED WITH, IN THE CONSTRUCTION OF THIS PROJECT.

I HEREBY CERTIFY THAT THIS PLAN WAS PREPARED BY ME OR UNDER MY DIRECT SUPERVISION AND THAT I AM A DULY REGISTERED PROFESSIONAL ENGINEER UNDER THE LAWS OF THE STATE OF MINNESOTA.

DESIGN DESIGNATION (RURAL)

ADT (CURRENT YEAR) 792 (2008)
 ADT (FUTURE YEAR) 1,108 (2028)
 9 TON DESIGN
 DESIGN SPEED 55 MPH
 SOIL FACTOR 130%
 SHOULDER WIDTH 6 FEET
 STOPPING SIGHT DISTANCE:
 HEIGHT OF EYE 3.5 FEET
 HEIGHT OF OBJECT 2.0 FEET

Kevin Pergman
 COUNTY ENGINEER

DATE 7/7/08

MARTIN COUNTY

REG. NO. 40,907

Al E. Haeder
 DISTRICT STATE AID ENGINEER: REVIEWED FOR COMPLIANCE WITH STATE AID RULES/POLICY.

DATE 7/24/08

Al E. Haeder
 APPROVED: FOR STATE AID FUNDING STATE AID ENGINEER.

DATE 7/24/08

TYPICAL SECTION BASE AND SURFACE SECTION (RURAL)

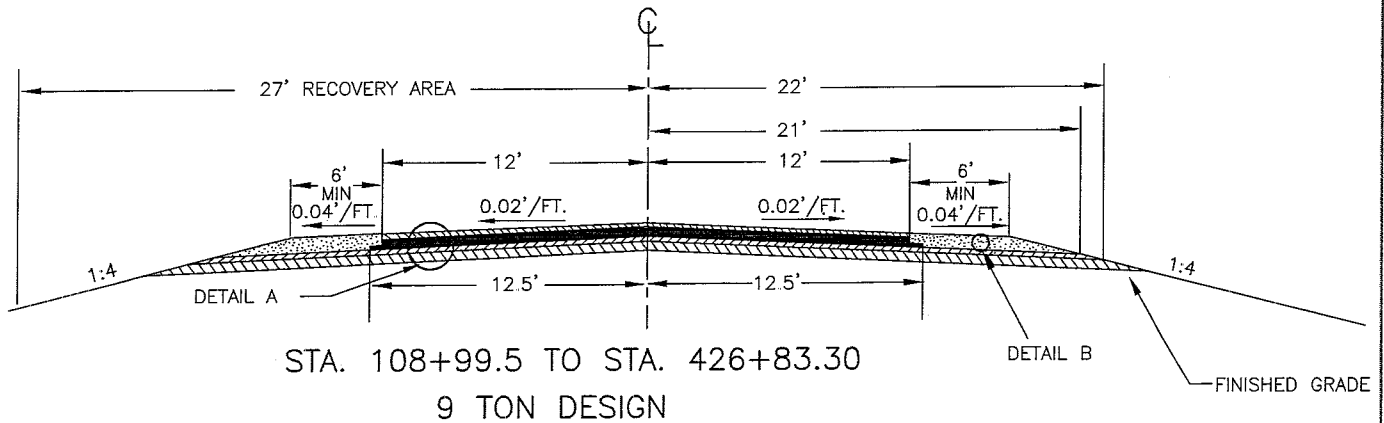

- 9 TON DESIGN
- ① 7" CLASS 4 GRAVEL SUB-BASE (3138) (INPLACE)
 - ② 2" CLASS 5 GRAVEL BASE (2221) (INPLACE)
 - ③ 1" ROAD MIXTURE BITUMINOUS BASE COURSE (2331 ??) (INPLACE)
 - ④ 1.5" PLANT MIXTURE WEAR COURSE (2331) (INPLACE)
 - ⑤ 1.5" PLANT MIXTURE LEVEL COURSE (2331) (INPLACE)
 - ⑥ 1.5" PLANT MIXTURE WEAR COURSE (2331) (INPLACE)
 - ⑦ 1.5" ASPHALT LEVEL TYPE (2360) SPWEA240B (PROPOSED)
 - ⑧ 1.5" ASPHALT WEAR TYPE (2360) SPWEA240B (PROPOSED)
 - ⑨ 3" AGGREGATE SHOULDERING CLASS 1 MOD. 2221 (PROPOSED)

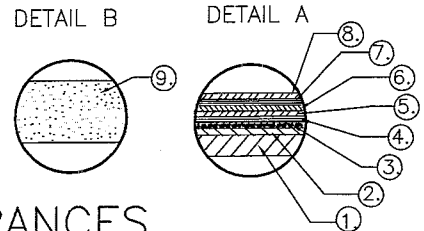

APPROACHES AND ENTRANCES

