

**FORMER PROJECTS**

S.A.P. 46-606-01 GRADING & GRAVELING -1965  
 S.A.P. 46-606-08 GRADING & GRAVELING -1968  
 S.A.P. 46-606-09 BITUMINOUS SURFACING -1970  
 C.P. 76:04 BITUMINOUS WEAR COURSE & AGGREGATE SHOULDERING -1976  
 S.A.P. 46-650-01 BITUMINOUS BASE & BITUMINOUS SURFACING -1976

**MINN PROJECT NO.**  
 MINNESOTA DEPARTMENT OF TRANSPORTATION  
**COUNTY STATE AID HIGHWAY NO. 50**

CONSTRUCTION PLAN FOR: BITUMINOUS WEAR COURSE  
& AGGREGATE SHOULDERING

LOCATED BETWEEN JCT. C.S.A.H. 39 EAST TO THE JCT. T.H. 15 IN TRUMAN  
 (GEOGRAPHIC DESCRIPTION)

LOCATED BETWEEN SE CORNER SECTION 12 T104N R31W  
TO SE CORNER SECTION 9 T104N R30W  
 (LEGAL DESCRIPTION)



**S.A.P. 46-650-07**

GROSS LENGTH 17,099.60 FEET 3.239 MILES  
 BRIDGES LENGTH 00.00 FEET 0.000 MILES  
 EXCEPTIONS LENGTH 00.00 FEET 0.000 MILES  
 NET LENGTH 17,099.60 FEET 3.239 MILES

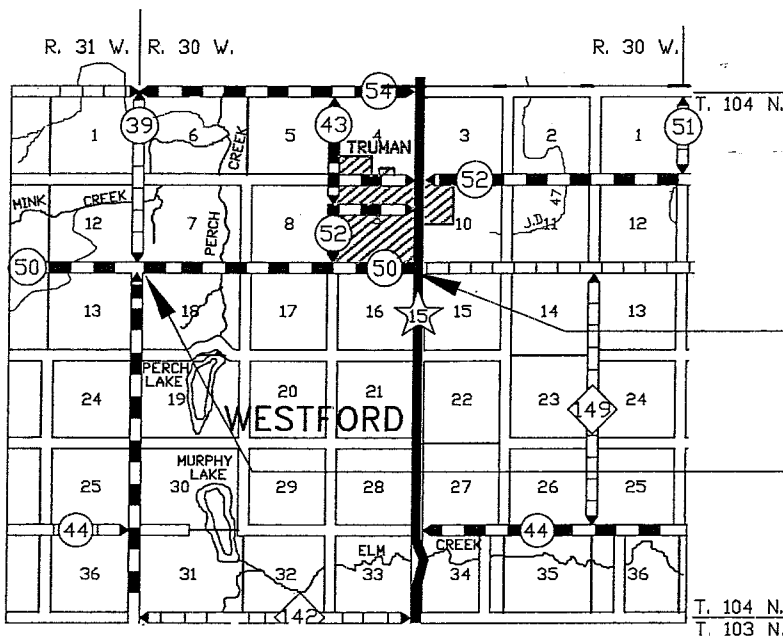

**INDEX OF SHEETS**

SHEET NO. 1 TITLE SHEET & LAYOUT MAP  
 SHEET NO. 2 ESTIMATED QUANTITIES  
 SHEET NO. 3 TYPICAL SECTIONS  
 THIS PLAN CONTAINS 3 SHEETS

END S.A.P. 46-650-07  
 STA. 491+37.9

BEGIN S.A.P. 46-650-07  
 STA. 320+38.3

**GOVERNING SPECIFICATIONS**

THE MINNESOTA DEPARTMENT OF TRANSPORTATION STANDARD SPECIFICATIONS FOR CONSTRUCTION 2005 EDITION DATED AUGUST 31, 2005.

ALL APPLICABLE FEDERAL, STATE, AND LOCAL LAWS AND ORDINANCES WILL BE COMPLIED WITH, IN THE CONSTRUCTION OF THIS PROJECT.

I HEREBY CERTIFY THAT THIS PLAN WAS PREPARED BY ME OR UNDER MY DIRECT SUPERVISION AND THAT I AM A DULY REGISTERED PROFESSIONAL ENGINEER UNDER THE LAWS OF THE STATE OF MINNESOTA.

DESIGN DESIGNATION (RURAL)

ADT (CURRENT YEAR) 1,370 (2008)  
 ADT (FUTURE YEAR) 1,918 (2028)  
 9 TON DESIGN  
 DESIGN SPEED 55 MPH  
 SOIL FACTOR 130%  
 SHOULDER WIDTH 6 FEET  
 STOPPING SIGHT DISTANCE:  
 HEIGHT OF EYE 3.5 FEET  
 HEIGHT OF OBJECT 2.0 FEET

*Kevin Payne*  
 COUNTY ENGINEER

DATE 7-7-08

MARTIN COUNTY

REG. NO. 40,907

*Al E. Haeder*  
 DISTRICT STATE AID ENGINEER: REVIEWED FOR COMPLIANCE WITH STATE AID RULES/POLICY.

DATE 7/24/08

*Al E. Haeder*  
 APPROVED: FOR STATE AID FUNDING, STATE AID ENGINEER.

DATE 7/24/08



# TYPICAL SECTION BASE AND SURFACE SECTION (RURAL)

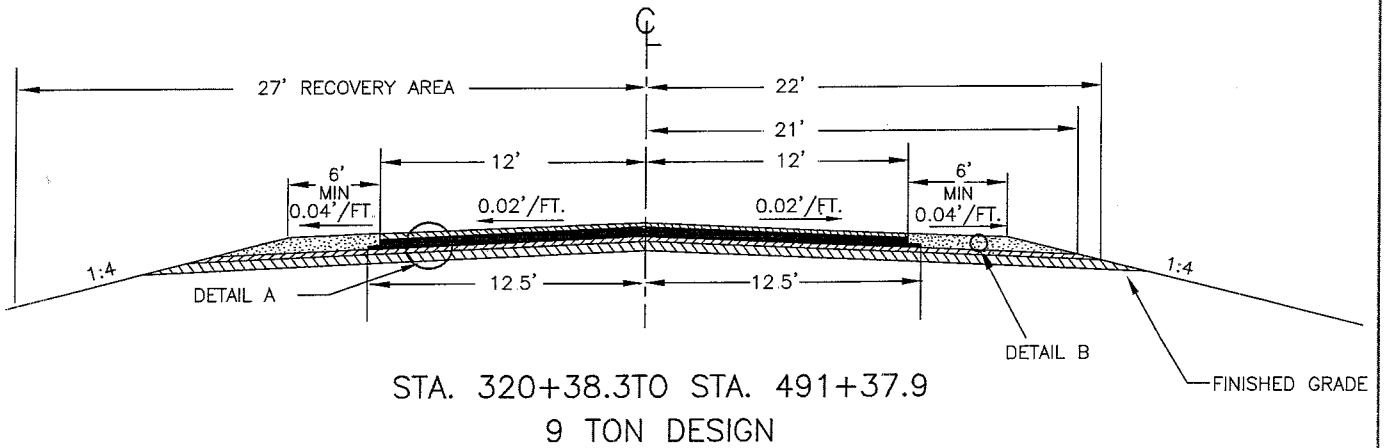

- 9 TON DESIGN
- ① 2" CLASS 5 AGGREGATE BASE (3138) (INPLACE)
  - ② 7" PLANT MIXTURE BITUMINOUS BASE (2331) (INPLACE)
  - ③ 1.5" PLANT MIXTURE BITUMINOUS WEAR COURSE (2341) (INPLACE)
  - ④ 1.5" ASPHALT WEAR TYPE (2360) SPWEA240B (PROPOSED)
  - ⑤ 1.5" ASPHALT WEAR TYPE (2360) SPWEA240B (PROPOSED)
  - ⑥ 3" AGGREGATE SHOULDERING CLASS 1 MOD. 2221 (PROPOSED)

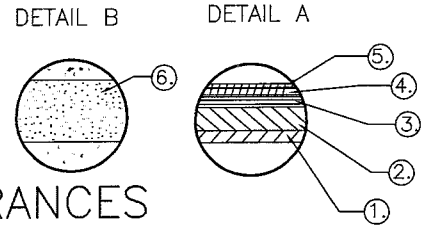

## APPROACHES AND ENTRANCES

