

SITE DRAWING EXAMPLE – new construction: shed

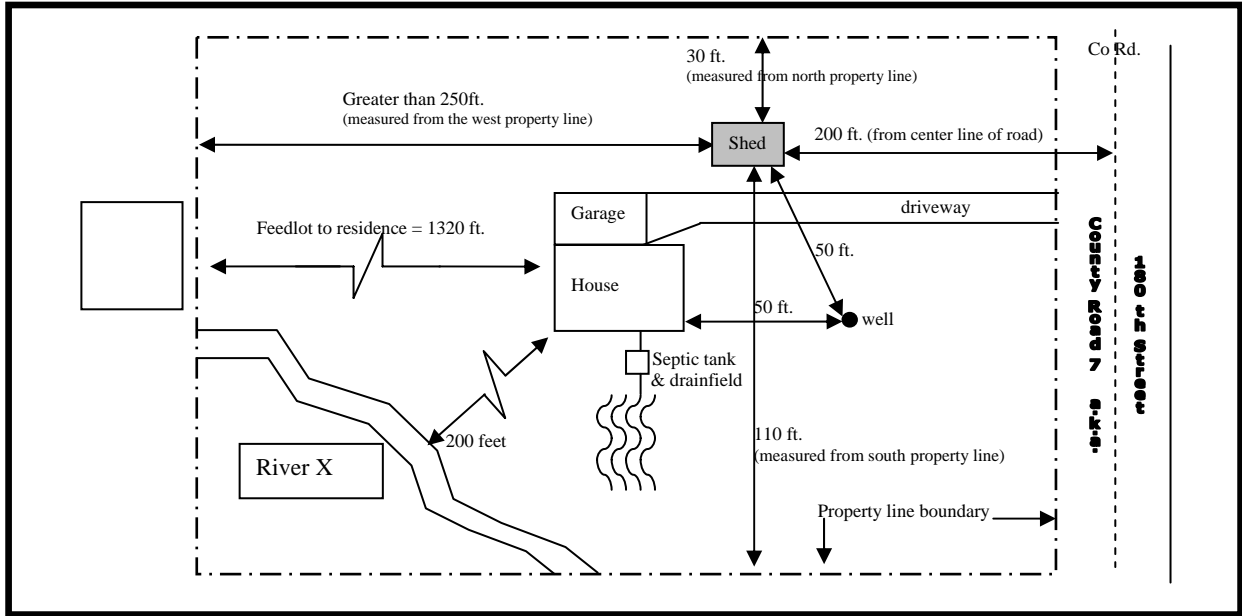

SITE DRAWING

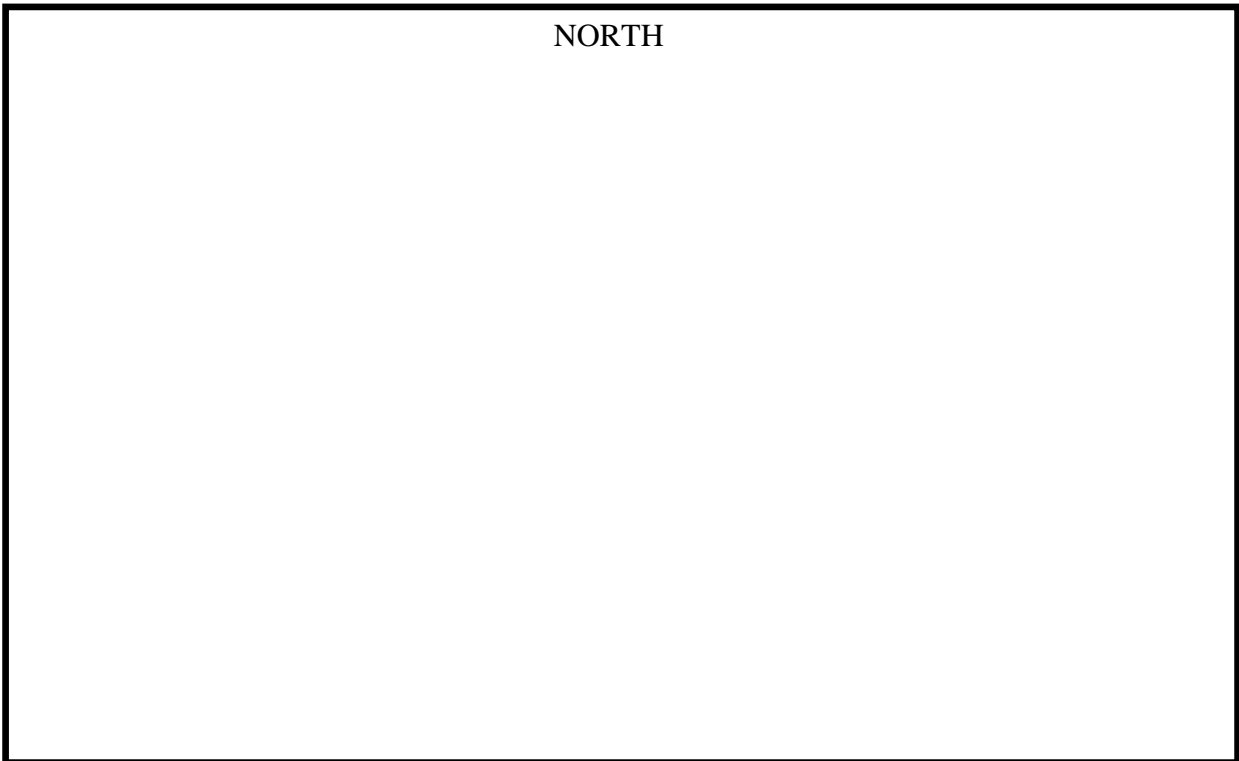

Yes No Is this site located within 1,000 feet of a water body such as a lake or wetland?

Yes No Is this site located within 300 feet of a river, stream or drainage ditch?

Yes No Is this site located within 2-miles of the incorporated City of Fairmont? ***If Yes***, please contact Randy Musser, **City of Fairmont**, Building Zoning Official regarding additional requirements and information. **507-238-9461**.

For dwelling and/or feedlot construction ONLY (including additions/alterations/modifications):

Yes No Unsure Is there a 1,320 feet between a neighboring residence and a feedlot (or vice-versa)?

When requested, Martin County Zoning Office will assist the applicant, to the best of their ability, to determine the distance between a residence and a feedlot. When Martin County cannot verify that the setback is met, a survey by a licensed surveyor may be required at the applicant's expense.

Applicant's signature

Date